

# Actuators

## Cartridge Cylinders

Ø 6-16 mm

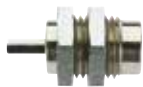

### CA - CAF Series

Pg. 15.3

## Mini Cylinders ISO 6432

Ø 8-25 mm



### Mini Series

Pg. 15.5

## Mini Stainless Steel ISO 6432

Ø 16-25 mm



### Mini Stainless Steel Series

Pg. 15.14

## Limited Space

Ø 32-63 mm



### A95 Series

Pg. 15.17

## Compact Cylinders

Ø 12-100 mm



### Q Series

Pg. 15.24

## ISO 15552 Cylinders

Ø 32-125 mm



### L Series

Pg. 15.37

## ISO 6431 Cylinders

Ø 160-320 mm



### E Series

Pg. 15.44

## ISO 15552 Cylinders

Ø 32-125 mm



### X Series

Pg. 15.46

## Stainless Steel ISO 15552

Ø 32-125 mm



### V Series

Pg. 15.51

## Twin Rod Cylinders

Ø 32-100 mm



### NHA Series

Pg. 15.54

## Compact Cylinders

Ø 20-100 mm



### W Series

Pg. 15.58

## Cylinder Accessories

ISO 6431 - ISO 15552 - ISO 21287



Pg. 15.66

## Guided Units

ISO 15552 - Ø 12-25 mm  
ISO 6431 VDMA - Ø 32-100 mm



Pg. 15.76

## Rodless Cylinders

Ø 16-63 mm



### R Series

Pg. 15.85

## Rotary Actuators

Ø 32-100 mm



### XR Series

Pg. 15.96

## Magnetic Position Sensing Switches

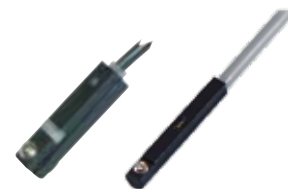

### Sensor

Pg. 15.99

PNEUMATIC ACTUATORS



**Actuators**

**SERIES XR - ROTARY ACTUATORS - ISO 15552**



**TECHNICAL CHARACTERISTICS**



Male output shaft



Female output shaft



**Reference Standard**

- 1907/2006  
**REACH** ✓
- 2011/65/CE  
**RoHS** ✓
- PED  
2014/68/UE
- SILICON  
FREE
- ATEX  
2014/34/UE



**Pressures**

- 1 bar** (0.1 MPa) / 14.5 psi
- 10 bar** (0.7 MPa) / 145 psi



**Temperatures**

- 0 °C / 32 °F** (-20 °C / -4 °F with dry air)
- + 80 °C / 176 °F**



**Media**

Filtered and lubricated or non-lubricated compressed air.



**Functions**

Double acting - cushioned - magnetic with male output shaft.  
Double acting - cushioned - magnetic with female output shaft.



**Bores**

from 32 to 100 mm

| Series  | Ø (mm)            | Rotation            |
|---|-------------------|---------------------|
| <b>X R M</b>  | <b>0 3 2</b>      | <b>0 9 0</b>        |
| <b>XRM</b> Rotary Actuator with Male Output Shaft and Angle Adjustment +/- 5°   | 032<br>040<br>050 | 90°<br>180°<br>270° |
| <b>XRF</b> Rotary Actuator with Female Output Shaft and Angle Adjustment +/- 5° | 063<br>080<br>100 | 360°                |



**Adjustable angle**

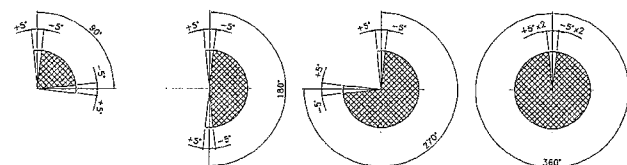

| Ø mm                                | Standard Rotation           |  |
|-------------------------------------|-----------------------------|--|
| <b>32 - 40 - 50 - 63 - 80 - 100</b> | 90°    180°    270°    360° |  |



**Torque at 1 bar**

| Ø mm       | Nm    |
|------------|-------|
| <b>32</b>  | 1.2   |
| <b>40</b>  | 2.25  |
| <b>50</b>  | 3.9   |
| <b>63</b>  | 7.3   |
| <b>80</b>  | 15.7  |
| <b>100</b> | 26.35 |

**CRM**

ROTARY ACTUATOR WITH MALE OUTPUT SHAFT AND ANGLE ADJUSTMENT +/- 5°

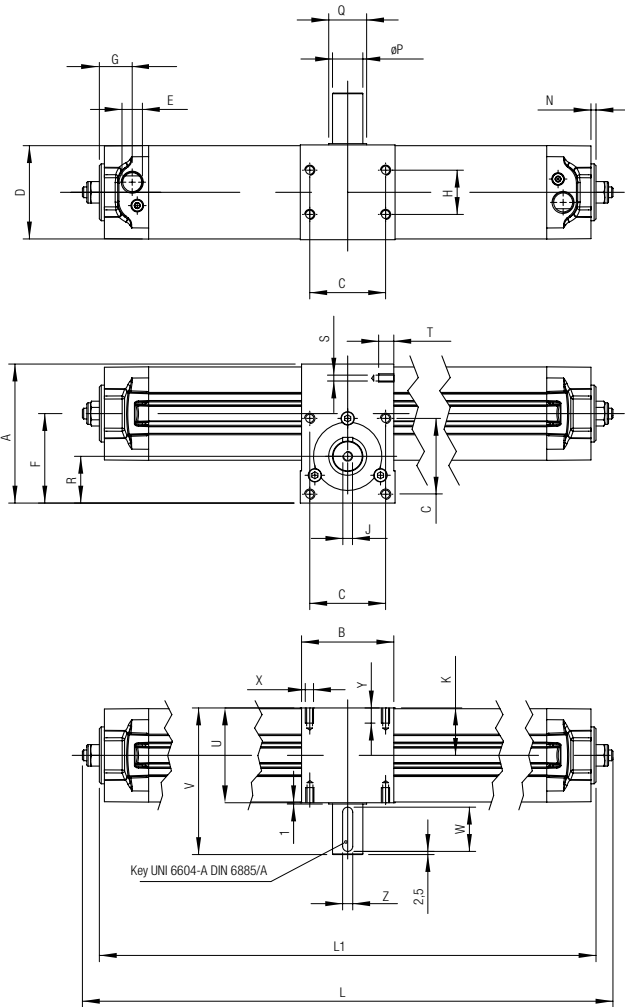

| Ø    | Rotation |     |    |     |         |      |       |    |     |       |      |    |       |      |      |      |     |       |    |     |     |    |
|------|----------|-----|----|-----|---------|------|-------|----|-----|-------|------|----|-------|------|------|------|-----|-------|----|-----|-----|----|
|      | 90°      |     |    |     |         | 180° |       |    |     |       | 270° |    |       |      |      | 360° |     |       |    |     |     |    |
| Ø    | A        | B   | C  | D   | E       | F    | G     | H  | J   | K     | N    | P  | Q     | R    | S    | T    | U   | V     | W  | X   | Y   | Z  |
| 322  | 71.5     | 302 | 33 | 46  | 213/8 G | 46.5 | 227/9 | 18 | M5  | 2605  | 4    | 14 | 32625 | 25   | M507 | 9    | 50  | 8373  | 25 | M6  | 304 | 5  |
| 400  | 82       | 304 | 40 | 54  | 251/4 G | 54.5 | 233/0 | 22 | M5  | 3130  | 4    | 14 | 38725 | 30   | M567 | 10   | 60  | 9464  | 25 | M6  | 424 | 5  |
| 500  | 94       | 301 | 50 | 64  | 276/4 G | 60.5 | 246/4 | 25 | M6  | 332.5 | 4    | 19 | 42730 | 32.5 | M602 | 8    | 65  | 10089 | 35 | M8  | 464 | 6  |
| 603  | 110      | 343 | 60 | 74  | 320/8 G | 70.8 | 2618  | 35 | M8  | 397.5 | 4    | 24 | 49330 | 37   | M870 | 10   | 75  | 11667 | 35 | M8  | 544 | 8  |
| 800  | 142      | 406 | 80 | 94  | 386/8 G | 93.5 | 2615  | 50 | M8  | 445.5 | 4    | 28 | 61445 | 50   | M884 | 12   | 99  | 1303  | 45 | M10 | 683 | 8  |
| 1000 | 156.5    | 449 | 80 | 111 | 418/2 G | 99   | 3056  | 60 | M10 | 537.5 | 4    | 38 | 66250 | 54   | M931 | 17   | 115 | 1669  | 45 | M10 | 788 | 10 |

Dimensions L and L1 for rotations.

**XRF**

ROTARY ACTUATOR WITH FEMALE OUTPUT SHAFT AND ANGLE ADJUSTMENT +/- 5°

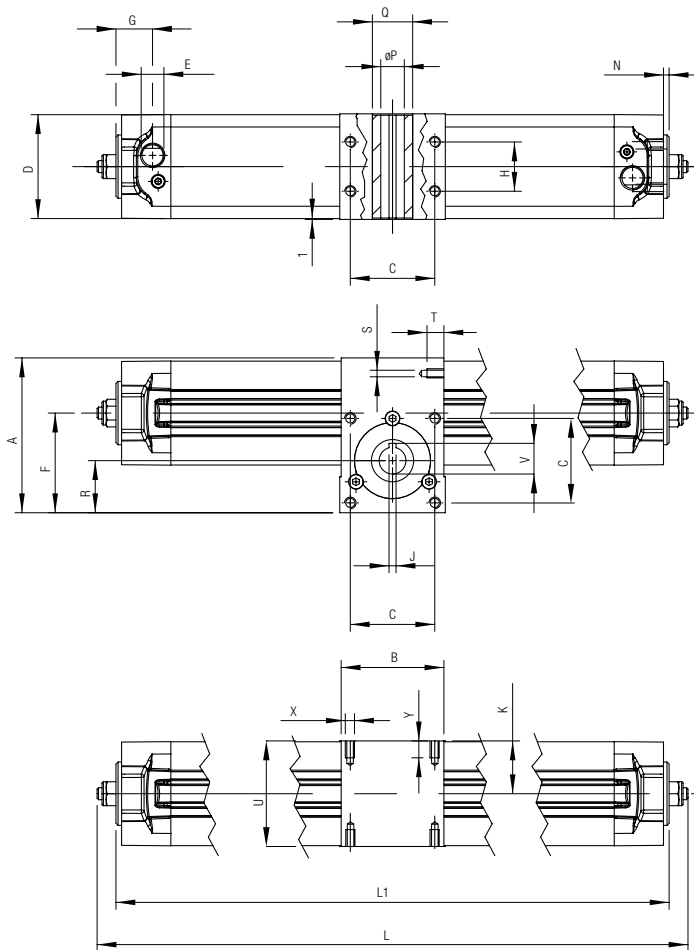

| Ø mm | Rotation |     |      |     |      |     |      |     |
|------|----------|-----|------|-----|------|-----|------|-----|
|      | 90°      |     | 180° |     | 270° |     | 360° |     |
|      | L        | L1  | L    | L1  | L    | L1  | L    | L1  |
| 32   | 232      | 213 | 279  | 260 | 326  | 307 | 373  | 354 |
| 40   | 274      | 254 | 330  | 310 | 387  | 367 | 464  | 424 |
| 50   | 301      | 276 | 364  | 339 | 427  | 402 | 489  | 464 |
| 63   | 343      | 320 | 418  | 395 | 493  | 470 | 567  | 544 |
| 80   | 416      | 386 | 515  | 485 | 614  | 584 | 713  | 683 |
| 100  | 449      | 418 | 556  | 525 | 662  | 631 | 769  | 738 |

Dimensions L and L1 for rotations.

| Ø   | A     | B   | C  | D   | E     | F    | G    | H  | J | K    | N | ØP | Q  | R    | S  | T  | U   | V    | X   | Y  |
|-----|-------|-----|----|-----|-------|------|------|----|---|------|---|----|----|------|----|----|-----|------|-----|----|
| 32  | 71.5  | 50  | 33 | 46  | 1/8 G | 46.5 | 22   | 18 | 5 | 25   | 4 | 14 | 25 | 25   | M5 | 9  | 50  | 16.3 | M6  | 10 |
| 40  | 82    | 60  | 40 | 54  | 1/4 G | 54.5 | 21.5 | 22 | 5 | 30   | 4 | 14 | 25 | 30   | M5 | 10 | 60  | 16.3 | M6  | 10 |
| 50  | 94    | 70  | 50 | 64  | 1/4 G | 60.5 | 24.5 | 25 | 6 | 32.5 | 4 | 19 | 30 | 32.5 | M6 | 8  | 65  | 21.8 | M8  | 13 |
| 63  | 110   | 75  | 60 | 74  | 3/8 G | 70.8 | 26   | 35 | 6 | 37.5 | 4 | 19 | 30 | 37   | M8 | 10 | 75  | 21.8 | M8  | 13 |
| 80  | 142   | 99  | 80 | 94  | 3/8 G | 93.5 | 26   | 50 | 8 | 49.5 | 4 | 24 | 45 | 50   | M9 | 12 | 99  | 27.3 | M10 | 16 |
| 100 | 156.5 | 115 | 80 | 111 | 1/2 G | 99   | 30   | 60 | 8 | 57.5 | 4 | 28 | 50 | 54   | M9 | 17 | 115 | 31.3 | M10 | 16 |