

**SERIE 120 UNI ISO 6150 B-12**



**CARATTERISTICHE TECNICHE**  
 TECHNICAL CHARACTERISTICS  
 TECHNISCHE ANGABEN  
 CARACTÉRISTIQUES TECHNIQUES  
 CARACTERÍSTICAS TÉCNICAS  
 CARACTERÍSTICAS TÉCNICAS



**Norma di Riferimento**

Reference standard

Entspricht der Norm

Norme de référence

Normativa de referencia

Norma de referência

1907/2006

REACH ✓

2011/65/CE

RoHS ✓

PED  
2014/68/UE

SILICON  
FREE

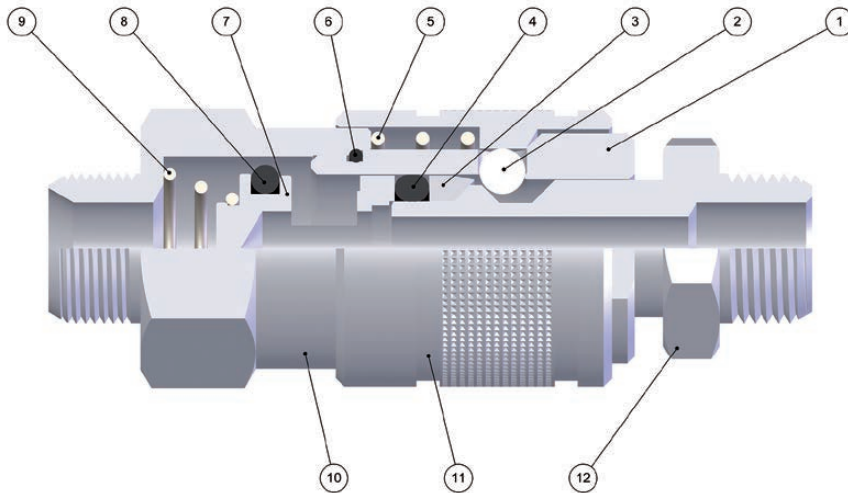

**FKM A RICHIESTA**  
 IF REQUESTED FKM  
 FKM AUF ANFRAGE  
 FKM SUR DEMANDE  
 FKM BAJO DEMANDA  
 FKM SOB ENCOMENDA

DN  
5.5 mm

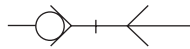

UNI ISO 6150 B-12

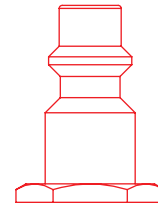

1:1

**Materiali e Componenti**

IT

- 1 Corpo in Ottone Nichelato
- 2 Sfera in Acciaio AISI 420
- 3 Anello Guida innesto in Ottone Nichelato
- 4 Guarnizione O-Ring in NBR
- 5 Molla Ghiera in Acciaio AISI 302
- 6 Guarnizione O-Ring in NBR
- 7 Otturatore in Ottone Nichelato
- 8 Guarnizione O-Ring in NBR 70
- 9 Molla Otturatore in Acciaio AISI 302
- 10 Attacco Terminale in Ottone Nichelato
- 11 Ghiera in Ottone Nichelato
- 12 Innesto in Ottone Nichelato

**Component Parts and Materials**

GB

- 1 Nickel-Plated Brass Body
- 2 Stainless Steel AISI 420 Balls
- 3 Nickel-Plated Brass Guide Ring Coupling
- 4 NBR O-Ring Seals
- 5 Stainless Steel AISI 302 Ring Nut Spring
- 6 NBR O-Ring Seals
- 7 Nickel-Plated Brass Shutter
- 8 NBR 70 O-Ring Seals
- 9 Stainless Steel AISI 302 Shutter Spring
- 10 Nickel-Plated Brass Coupling Back Part
- 11 Nickel-Plated Brass Sleeve
- 12 Nickel-Plated Brass Plug Outline

**Komponenten und Materialien**

DE

- 1 Körper Messing Vernickelt
- 2 Kugel Edelstahl AISI 420
- 3 Stecker Führungsring Messing Vernickelt
- 4 O-Ring NBR
- 5 Entriegelungsfeder Edelstahl AISI 302
- 6 O-Ring NBR
- 7 Verschluss Messing Vernickelt
- 8 O-Ring NBR
- 9 Verschlussfeder Edelstahl AISI 302
- 10 Einschraubkörper Messing Vernickelt
- 11 Entriegelungshülse Messing Vernickelt
- 12 Stecker Messing Vernickelt

**Matériaux et Composants**

FR

- 1 Corps: Laiton Nickelé
- 2 Bille: Acier Inoxydable AISI 420
- 3 Bague de Guidage: Laiton Nickelé
- 4 Joint Torique en NBR
- 5 Ressort de Bague: Acier Inoxydable AISI 302
- 6 Joint Torique en NBR
- 7 Clapet: Laiton Nickelé
- 8 Joint Torique en NBR
- 9 Ressort de Clapet: Acier Inoxydable AISI 302
- 10 Corps: Laiton Nickelé
- 11 Bague: Laiton Nickelé
- 12 Embout: Laiton Nickelé

**Materiales y Componentes**

ES

- 1 Cuerpo en latón niquelado
- 2 Esfera en acero AISI 420
- 3 Anillo guía enchufe en latón niquelado
- 4 Junta tórica en NBR
- 5 Muelle tuerca en acero AISI 302
- 6 Junta tórica en NBR
- 7 Obturador en latón niquelado
- 8 Junta tórica en NBR 70
- 9 Muelle obturador en acero AISI 302
- 10 Terminal de conexión en latón niquelado
- 11 Tuerca en latón niquelado
- 12 Enchufe en latón niquelado

**Materiais e Componentes**

PT

- 1 Corpo em Latão Niquelado
- 2 Esfera em aço AISI 420
- 3 Anel guia do plug em latão niquelado
- 4 Vedação O-Ring em NBR
- 5 Mola da porca em aço AISI 302
- 6 Vedação O-Ring em NBR
- 7 Obturador em latão niquelado
- 8 Vedação O-Ring em NBR 70
- 9 Mola do obturador em aço AISI 302
- 10 Conexão terminal em latão niquelado
- 11 Porca em latão niquelado
- 12 Plug em latão niquelado



### Pressione d'esercizio

Working Pressures

Betriebsdruck

Pression de service

Presión de Ejercicio

Pressão de Trabalho

**0 bar**

**16 bar**



### Max pressione statica (no pulsazioni)

Maximum static pressure (no pulsations)

Maximaler statischer Betriebsdruck (ohne pulsations)

Pression statique maximale (sans pulsation)

Presión estática máxima (sin pulsaciones)

Pressão estática máxima (sem pulsações)

**35 bar**



### Temperature

Temperatures

Temperatur

Températures

Temperaturas

Temperaturas

**- 20 °C**

**+ 80 °C**

Con O-ring in FKM

With FKM O-ring

Mit O-ring in FKM

Avec joints en FKM

Con junta tórica en FKM

Com O-ring em FKM

**- 10 °C**

**+ 200 °C**



### Fluidi compatibili

Aria compressa

Fluids

Compressed air

Geeignete Medien

Druckluft

Fluides compatibles

Air comprimé

Fluidos compatibles

Aire comprimido

Fluidos compatíveis

Ar comprimido

Per altri fluidi, consultare l'ufficio tecnico Aignep.

For other fluids, consult the technical department Aignep.

Für andere Flüssigkeiten, kontaktieren Sie uns.

Pour d'autres fluides, veuillez nous consulter.

Para otros fluidos póngase en contacto con el departamento técnico Aignep.

Para outros fluidos consulte o departamento técnico da Aignep.



### Portata

NI/min

Flow Rate

Durchflusswerte

Débit

Caudal de Flujo

Vazão

6 bar Δ 1	6 bar Δ 0.5	6 bar *
1100	800	1500

\* Scarico libero - Exhaust Free - Freier Auslass - Échappement libre - Escape Libre - Descarga livre.



### Filettatura

IT

Gas cilindrica conforme ISO 228 Classe A.

### Threads

GB

Parallel gas in conformity with ISO 228 Class A.

### Gewindearten

DE

Zylindrisches Gewinde nach Norm ISO 228 Classe A.

### Filetages

FR

Filetage cylindrique conforme: ISO 228 Class A.

### Roscas

ES

Gas cilindrica conforme ISO 228 Clase A.

### Roscas

PT

Gas paralela conforme ISO 228 Classe A.

## 121

### PRESA MASCHIO

MALE SOCKET

VERSCHLUSS-KUPPLUNG MIT AUSSENGEWINDE

COUPLEUR MÂLE

ENCHUFE MACHO

SOQUETE COM ROSCA MACHO

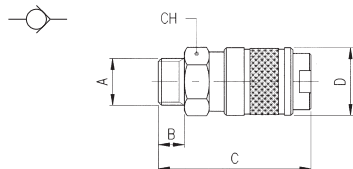

Code	A	B	C	D	CH	Pack.
00121 00 001	1/4	8	53	24	21	10
00121 00 002	3/8	9	54	24	21	10
00121 00 003	1/2	10	55	24	24	10

## 122

### PRESA FEMMINA

FEMALE SOCKET

VERSCHLUSS-KUPPLUNG MIT INNENGEWINDE

COUPLEUR FEMELLE

ENCHUFE HEMBRA

SOQUETE COM ROSCA FÊMEA

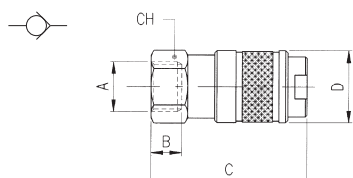

Code	A	B	C	D	CH	Pack.
00122 00 001	1/4	11	55	24	21	10
00122 00 002	3/8	11.5	55.5	24	21	10
00122 00 003	1/2	14	59	24	24	10

## 123

### PRESA A CALZAMENTO CON MOLLA

COMPRESSION SOCKET WITH SPRING

VERSCHLUSS-KUPPLUNG MIT KNICKSCHUTZFEDER

COUPLEUR AVEC RESSORT DE PROTECTION

ENCHUFE TUBO CON MUELLE

SOQUETE COM CONEXÃO PUSH-ON COM MOLLA

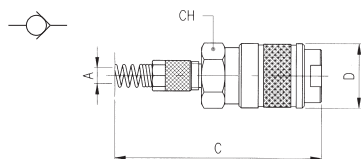

Code	A	C	D	CH	Pack.
00123 00 001	6/4	141	24	21	10
00123 00 002	8/6	146.5	24	21	10
00123 00 003	10/8	154	24	21	10

Molla Acciaio Inox AISI 304 - EN 1.4301  
 Stainless Steel Spring AISI 304 - EN 1.4301  
 Edelstahlfeder AISI 304 - EN 1.4301  
 Ressort Acier Inoxydable AISI 304 - EN 1.4301  
 Muelle Acero Inoxidable AISI 304 - EN 1.4301  
 Mola Aço Inoxidável AISI 304 - EN 1.4301

## 124

### PRESA A CALZAMENTO

COMPRESSION SOCKET

VERSCHLUSS-KUPPLUNG MIT ÜBERWURFVERSCHRAUBUNG

COUPLEUR RACCORD À COIFFE

ENCHUFE TUBO

SOQUETE COM CONEXÃO PUSH-ON

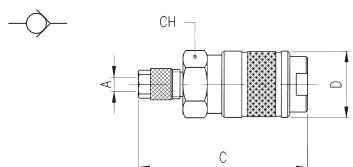

Code	A	C	D	CH	Pack.
00124 00 001	6/4	59	24	21	10
00124 00 002	8/6	59	24	21	10
00124 00 003	10/8	60	24	21	10

## 125

### PRESA CON PORTAGOMMA A RESCA

BARBED SOCKET

VERSCHLUSS-KUPPLUNG MIT SCHLAUCHTÜLLE

COUPLEUR À DOUILLE ANNELÉE POUR TUBE

ENCHUFE ESPIGA

SOQUETE COM ESPIGÃO PARA MANGUEIRA DE BORRACHA

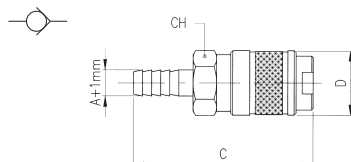

Code	A	C	D	CH	Pack.
00125 00 001	6	64	24	21	10
00125 00 002	8	64	24	21	10
00125 00 003	10	64	24	21	10
00125 00 004	12	64	24	21	10

## 126

### PRESA CON PORTAGOMMA

SOCKET FOR RUBBER HOSE

VERSCHLUSS-KUPPLUNG FÜR GUMMISCHLAUCH

COUPLEUR POUR TUBE

ENCHUFE CON PORTAGOMA

SOQUETE COM ESPIGÃO PARA TUBO DE BORRACHA

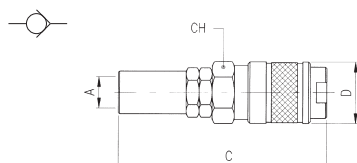

Code	A	C	D	CH	Pack.
00126 00 001	14/6	72	24	21	10
00126 00 002	17/8	72	24	21	10
00126 00 003	19/10	72	24	21	10

## 221

### INNESTO MASCHIO

MALE PLUG

STECKER MIT AUSSENGEWINDE

EMBOUT MÂLE

ADAPTADOR MACHO

PLUG COM ROSCA MACHO

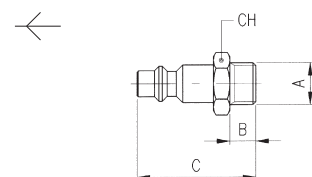

Code	A	B	C	CH	Pack.
00221 00 01 03 NB	1/4	8	36.5	17	10
00221 00 01 04 NB	3/8	9	37.5	19	10
00221 00 01 05 NB	1/2	10	39	24	10

## 221AC

### INNESTO IN ACCIAIO MASCHIO

STEEL MALE PLUG

STECKER MIT AUSSENGEWINDE AUS STAHL

EMBOUT MÂLE EN ACIER

ADAPTADOR EN ACERO MACHO

PLUG EM AÇO COM ROSCA MACHO

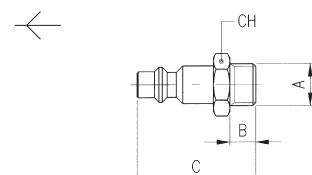

Code	A	B	C	CH	Pack.
221AC 00 51 03 ZI	1/4	8	36.5	17	10
221AC 00 51 04 ZI	3/8	9	37.5	19	10
221AC 00 51 05 ZI	1/2	10	39	24	10

**Acciaio Indurito**  
 Hardened Steel  
 Gehärtetem Stahl  
 Acier Trempé  
 Acero Curtido  
 Aço Endurecido

## 222

### INNESTO FEMMINA

FEMALE PLUG  
 STECKER MIT INNENGEWINDE  
 EMBOUT FEMELLE  
 ADAPTADOR HEMBRA  
 PLUG COM ROSCA FÊMEA

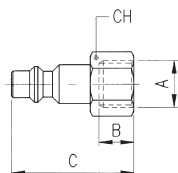

Code	A	B	C	CH	Pack.
00222 00 01 03 NB	1/4	11	36.5	17	10
00222 00 01 04 NB	3/8	11.5	37	19	10
00222 00 01 05 NB	1/2	15	40.5	24	10

## 222AC

### INNESTO IN ACCIAIO FEMMINA

STEEL FEMALE PLUG  
 STECKER MIT INNENGEWINDE AUS STAHL  
 EMBOUT FEMELLE EN ACIER  
 ADAPTADOR EN ACERO HEMBRA  
 PLUG EM AÇO COM ROSCA FÊMEA

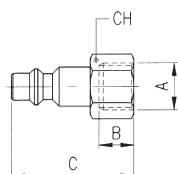

Code	A	B	C	CH	Pack.
222AC 00 51 03 ZI	1/4	11	36.5	17	10
222AC 00 51 04 ZI	3/8	11.5	37	19	10
222AC 00 51 05 ZI	1/2	15	40.5	24	10

**Acciaio Indurito**  
 Hardened Steel  
 Gehärtetem Stahl  
 Acier Trempé  
 Acero Curtido  
 Aço Endurecido

## 223

### INNESTO A CALZAMENTO CON MOLLA

COMPRESSION PLUG WITH SPRING  
 STECKER MIT KNICKSCHUTZFEDER  
 EMBOUT AVEC RESSORT DE PROTECTION  
 ADAPTADOR TUBO CON MUELLE  
 PLUG COM CONEXÃO PUSH-ON COM MOLA

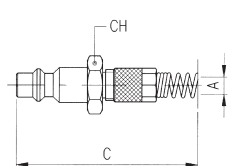

Code	A	C	CH	Pack.
00223 00 001	6/4	123	13	10
00223 00 002	8/6	128.5	13	10
00223 00 003	10/8	136	14	10
00223 00 004	12/10	142	16	10

**Molla Acciaio Inox AISI 304 - EN 1.4301**  
 Stainless Steel Spring AISI 304 - EN 1.4301  
 Edelstahlfeder AISI 304 - EN 1.4301  
 Ressort Acier Inoxydable AISI 304 - EN 1.4301  
 Muelle Acero Inoxidable AISI 304 - EN 1.4301  
 Mola Aço Inoxidável AISI 304 - EN 1.4301

## 224

### INNESTO A CALZAMENTO

COMPRESSION PLUG  
 STECKER MIT ÜBERWURFVERSCHRAUBUNG  
 EMBOUT À RACCORD À COIFFE  
 ADAPTADOR TUBO  
 PLUG COM CONEXÃO PUSH-ON

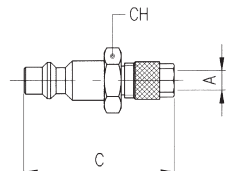

Code	A	C	CH	Pack.
00224 00 001	6/4	41	13	10
00224 00 002	8/6	41	13	10
00224 00 003	10/8	43	14	10
00224 00 004	12/10	45	16	10

**225**

**INNESTO CON PORTAGOMMA A RESCA**

BARBED PLUG  
 STECKER MIT SCHLAUCHTÜLLE  
 EMBOUT À DOUILLE ANNELÉE POUR TUBE  
 ADAPTADOR ESPIGA  
 PLUG COM ESPIGÃO PARA TUBO DE BORRACHA

Code	A	C	D	Pack.
00225 00 01 X4 NB	6	43.5	12	10
00225 00 01 X7 NB	8	43.5	12	10
00225 00 01 X9 NB	10	46	14	10
00225 00 01 Y1 NB	12	46	16	10

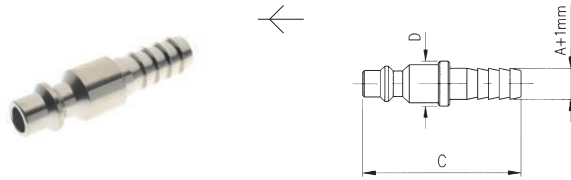

**225AC**

**INNESTO IN ACCIAIO CON PORTAGOMMA A RESCA**

STEEL BARBED PLUG  
 STECKER MIT SCHLAUCHTÜLLE AUS STAHL  
 EMBOUT À DOUILLE ANNELÉE POUR TUBE EN ACIER  
 ADAPTADOR EN ACERO ESPIGA  
 PLUG EM AÇO COM ESPIGÃO PARA TUBO DE BORRACHA

Code	A	C	D	Pack.
225AC 00 51 X4 ZI	6	43.5	12	10
225AC 00 51 X7 ZI	8	43.5	12	10
225AC 00 51 X9 ZI	10	46	14	10
225AC 00 51 Y1 ZI	12	46	16	10

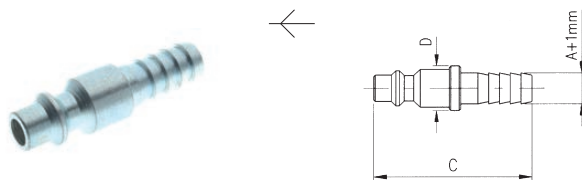

**Acciaio Indurito**  
 Hardened Steel  
 Gehärtetem Stahl  
 Acier Trempé  
 Acero Curtido  
 Aço Endurecido

**227**

**INNESTO A BAIONETTA**

BAYONET PLUG  
 STECKER MIT BAJONETT-VERSCHLUSS  
 EMBOUT À RACCORD À BAIONNETTE  
 ADAPTADOR BAYONETA  
 PLUG COM CONEXÃO TIPO BAIONETA

Code	A	C	CH	Pack.
00227 00 001	15	37	15	10

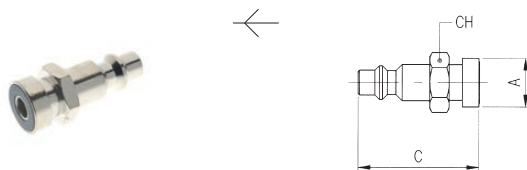

**228**

**INNESTO A SCARICO PROGRESSIVO**

PLUG WITH GRADUAL EXHAUST  
 STECKER MIT PROGRESSIVER ENTLASTUNG  
 EMBOUT À PASSAGE PROGRESSIF  
 ADAPTADOR DE DESCARGA PROGRESIVA  
 PLUG COM ESCAPE PROGRESSIVO

Code	A	B	C	CH	Pack.
00228 00 001	1/4	11	45	17	10

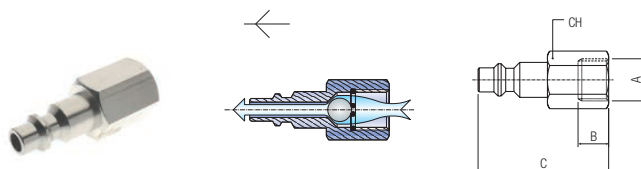

**SERIE 120 ITALIAN PROFILE**



**CARATTERISTICHE TECNICHE**  
 TECHNICAL CHARACTERISTICS  
 TECHNISCHE ANGABEN  
 CARACTÉRISTIQUES TECHNIQUES  
 CARACTERÍSTICAS TÉCNICAS  
 CARACTERÍSTICAS TÉCNICAS



**Norma di Riferimento**

Reference standard

Entspricht der Norm

Norme de référence

Normativa de referencia

Norma de referência

1907/2006  
**REACH** ✓

2011/65/CE  
**RoHS** ✓

PED  
 2014/68/UE

**SILICON  
 FREE**

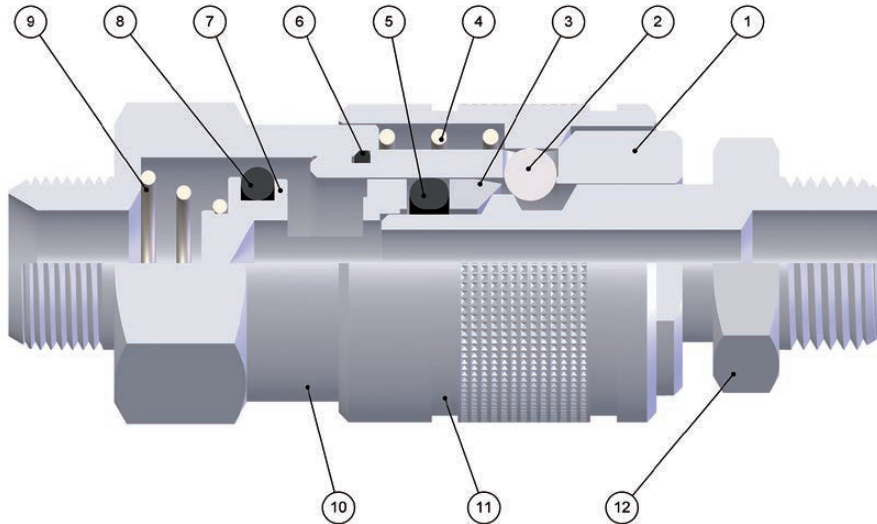

**FKM A RICHIESTA**  
 IF REQUESTED FKM  
 FKM AUF ANFRAGE  
 FKM SUR DEMANDE  
 FKM BAJO DEMANDA  
 FKM SOB ENCOMENDA

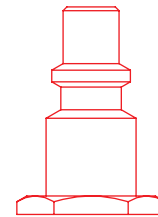
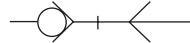

1:1

**Materiali e Componenti**

IT

- 1 Corpo in Ottone Nichelato
- 2 Sfera in Acciaio AISI 420
- 3 Anello Guida Innesto in Ottone Nichelato
- 4 Molla Ghiera in Acciaio AISI 302
- 5 Guarnizione O-Ring in NBR
- 6 Guarnizione O-Ring in NBR
- 7 Otturatore in Ottone Nichelato
- 8 Guarnizione O-Ring in NBR
- 9 Molla Otturatore in Acciaio AISI 302
- 10 Attacco Terminale in Ottone Nichelato
- 11 Ghiera in Ottone Nichelato
- 12 Innesto in Ottone Nichelato

**Component Parts and Materials**

GB

- 1 Nickel-Plated Brass Body
- 2 Stainless Steel AISI 420 Balls
- 3 Nickel-Plated Brass Guide Ring Coupling
- 4 Stainless Steel AISI 302 Ring Nut Spring
- 5 NBR O-Ring Seals
- 6 NBR O-Ring Seals
- 7 Nickel-Plated Brass Shutter
- 8 NBR O-Ring Seals
- 9 Stainless Steel AISI 302 Shutter Spring
- 10 Nickel-Plated Brass Coupling Back Part
- 11 Nickel-Plated Brass Sleeve
- 12 Nickel-Plated Brass Plug Outline

**Komponenten und Materialien**

DE

- 1 Körper Messing Vernickelt
- 2 Kugel Edelstahl AISI 420
- 3 Stecker Führungsring Messing Vernickelt
- 4 Entriegelungsfeder Edelstahl AISI 302
- 5 O-Ring NBR
- 6 O-Ring NBR
- 7 Verschluss Messing Vernickelt
- 8 O-Ring NBR
- 9 Verschlussfeder Edelstahl AISI 302
- 10 Einschraubkörper Messing Vernickelt
- 11 Entriegelungshülse Messing Vernickelt
- 12 Stecker Messing Vernickelt

**Matériaux et Composants**

FR

- 1 Corps: Laiton Nickelé
- 2 Bille: Acier Inoxydable AISI 420
- 3 Bague de Guidage: Laiton Nickelé
- 4 Ressort de Bague: Acier Inoxydable AISI 302
- 5 Joint Torique en NBR
- 6 Joint Torique en NBR
- 7 Clapet: Laiton Nickelé
- 8 Joint Torique en NBR
- 9 Ressort de Clapet: Acier Inoxydable AISI 302
- 10 Corps: Laiton Nickelé
- 11 Bague: Laiton Nickelé
- 12 Embout: Laiton Nickelé

**Materiales y Componentes**

ES

- 1 Cuerpo en Latón niquelado
- 2 Esfera en acero AISI 420
- 3 Anillo guía enchufe en latón niquelado
- 4 Muelle tuerca en acero AISI 302
- 5 Junta tórica en NBR
- 6 Junta tórica en NBR
- 7 Obturador en latón niquelado
- 8 Junta tórica en NBR
- 9 Muelle obturador en acero AISI 302
- 10 Terminal de conexión en latón niquelado
- 11 Tuerca en latón niquelado
- 12 Enchufe en latón niquelado

**Materiais e Componentes**

PT

- 1 Corpo em Latão Niquelado
- 2 Esfera em aço AISI 420
- 3 Anel guia do plug em latão niquelado
- 4 Mola da porca em aço AISI 302
- 5 Vedação O-Ring em NBR
- 6 Vedação O-Ring em NBR
- 7 Obturador em latão niquelado
- 8 Vedação O-Ring em NBR
- 9 Mola do obturador em aço AISI 302
- 10 Conexão terminal em latão niquelado
- 11 Porca em latão niquelado
- 12 Plug em latão niquelado



### Pressione d'esercizio

Working Pressures

Betriebsdruck

Pression de service

Presión de Ejercicio

Pressão de Trabalho

**0 bar**

**16 bar**



### Max pressione statica (no pulsazioni)

Maximum static pressure (no pulsations)

Maximaler statischer Betriebsdruck (ohne pulsations)

Pression statique maximale (sans pulsation)

Presión estática máxima (sin pulsaciones)

Pressão estática máxima (sem pulsações)

**35 bar**



### Temperature

Temperatures

Temperatur

Températures

Temperaturas

Temperaturas

**- 20 °C**

**+ 80 °C**

Con O-ring in FKM

With FKM O-ring

Mit O-ring in FKM

Avec joints en FKM

Con junta tórica en FKM

Com O-ring em FKM

**- 10 °C**

**+ 200 °C**



### Fluidi compatibili

Aria compressa

Fluids

Compressed air

Geeignete Medien

Druckluft

Fluides compatibles

Air comprimé

Fluidos compatibles

Aire comprimido

Fluidos compatíveis

Ar comprimido

**Per altri fluidi, consultare l'ufficio tecnico Aignep.**

For other fluids, consult the technical department Aignep.

Für andere Flüssigkeiten, kontaktieren Sie uns.

Pour d'autres fluides, veuillez nous consulter.

Para otros fluidos póngase en contacto con el departamento técnico Aignep.

Para outros fluidos consulte o departamento técnico da Aignep.



### Portata

NI/min

Flow Rate

Durchflusswerte

Débit

Caudal de Flujo

Vazão

6 bar Δ 1	6 bar Δ 0.5	6 bar *
1100	800	1500

\* Scarico libero - Exhaust Free - Freier Auslass - Échappement libre - Escape Libre - Descarga libre.



### Filettatura

IT

### Threads

GB

### Gewindearten

DE

Gas cilindrica conforme ISO 228 Classe A.

Parallel gas in conformity with ISO 228 Class A.

Zylindrisches Gewinde nach Norm ISO 228 Classe A.

### Filetages

FR

### Roscas

ES

### Roscas

PT

Filetage cylindrique conforme: ISO 228 Class A.

Gas cilíndrica conforme ISO 228 Classe A.

Gas paralela conforme ISO 228 Classe A.

## 121

### PRESA MASCHIO

MALE SOCKET  
MIT AUSSENGEWINDE  
COUPLEUR MÂLE  
ENCHUFE MACHO  
SOQUETE COM ROSCA MACHO

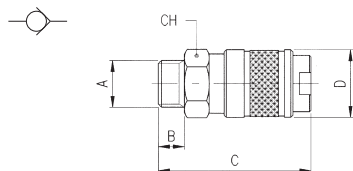

Code	A	B	C	D	CH	Pack.
00121 00 001	1/4	8	53	24	21	10
00121 00 002	3/8	9	54	24	21	10
00121 00 003	1/2	10	55	24	24	10

## 122

### PRESA FEMMINA

FEMALE SOCKET  
VERSCHLUSS-KUPPLUNG MIT INNENGEWINDE  
COUPLEUR FEMELLE  
ENCHUFE HEMBRA  
SOQUETE COM ROSCA FÊMEA

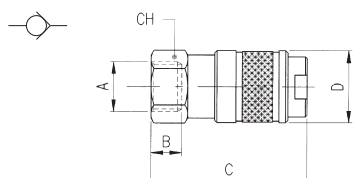

Code	A	B	C	D	CH	Pack.
00122 00 001	1/4	11	55	24	21	10
00122 00 002	3/8	11.5	55.5	24	21	10
00122 00 003	1/2	14	59	24	24	10

## 123

### PRESA A CALZAMENTO CON MOLLA

COMPRESSION SOCKET WITH SPRING  
VERSCHLUSS-KUPPLUNG MIT KNICKSCHUTZFEDER  
COUPLEUR AVEC RESSORT DE PROTECTION  
ENCHUFE TUBO CON MUELLE  
SOQUETE COM CONEXÃO PUSH-ON COM MOLLA

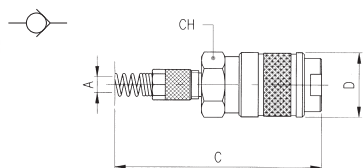

Code	A	C	D	CH	Pack.
00123 00 001	6/4	141	24	21	10
00123 00 002	8/6	146.5	24	21	10
00123 00 003	10/8	154	24	21	10

Molla Acciaio Inox AISI 304 - EN 1.4301  
Stainless Steel Spring AISI 304 - EN 1.4301  
Edelstahlfeder AISI 304 - EN 1.4301  
Ressort Acier Inoxydable AISI 304 - EN 1.4301  
Muelle Acero Inoxidable AISI 304 - EN 1.4301  
Mola Aço Inoxidável AISI 304 - EN 1.4301

## 124

### PRESA A CALZAMENTO

COMPRESSION SOCKET  
VERSCHLUSS-KUPPLUNG MIT ÜBERWURFVERSCHRAUBUNG  
COUPLEUR RACCORD À COIFFE  
ENCHUFE TUBO  
SOQUETE COM CONEXÃO PUSH-ON

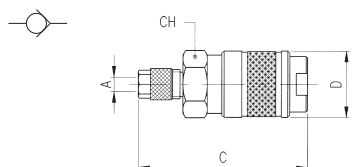

Code	A	C	D	CH	Pack.
00124 00 001	6/4	59	24	21	10
00124 00 002	8/6	59	24	21	10
00124 00 003	10/8	60	24	21	10

## 125

### PRESA CON PORTAGOMMA A RESCA

BARBED SOCKET

VERSCHLUSS-KUPPLUNG MIT SCHLAUCHTÜLLE

COUPLEUR À DOUILLE ANNELÉE POUR TUBE

ENCHUFE ESPIGA

SOQUETE COM ESPIGÃO PARA MANGUEIRA DE BORRACHA

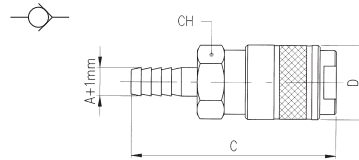

Code	A	C	D	CH	Pack.
00125 00 001	6	64	24	21	10
00125 00 002	8	64	24	21	10
00125 00 003	10	64	24	21	10
00125 00 004	12	64	24	21	10

## 126

### PRESA CON PORTAGOMMA

SOCKET FOR RUBBER HOSE

VERSCHLUSS-KUPPLUNG FÜR GUMMISCHLAUCH

COUPLEUR A DOUILLE POUR TUBE

ENCHUFE CON PORTAGOMA

SOQUETE COM ESPIGÃO PARA TUBO DE BORRACHA

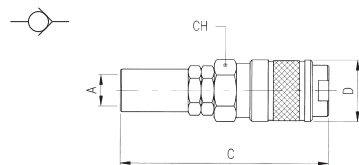

Code	A	C	D	CH	Pack.
00126 00 001	14/6	72	24	21	10
00126 00 002	17/8	72	24	21	10
00126 00 003	19/10	72	24	21	10

## 251

### INNESTO MASCHIO

MALE PLUG

STECKER MIT AUSSENGEWINDE

EMBOUT MÂLE

ADAPTADOR MACHO

PLUG COM ROSCA MACHO

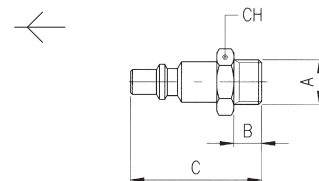

Code	A	B	C	CH	Pack.
00251 00 01 03 NB	1/4	8	38	17	10
00251 00 01 04 NB	3/8	9	39	19	10
00251 00 01 05 NB	1/2	10	40.5	24	10

## 251AC

### INNESTO IN ACCIAIO MASCHIO

STEEL MALE PLUG

STECKER MIT AUSSENGEWINDE AUS STAHL

EMBOUT MÂLE EN ACIER

ADAPTADOR EN ACERO MACHO

PLUG EM AÇO COM ROSCA MACHO

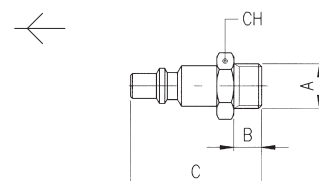

Code	A	B	C	CH	Pack.
251AC 00 51 03 ZI	1/4	8	38	17	10
251AC 00 51 04 ZI	3/8	9	39	19	10
251AC 00 51 05 ZI	1/2	10	40.5	24	10

**Acciaio Indurito**  
 Hardened Steel  
 Gehärtetem Stahl  
 Acier Trempé  
 Acero Curtido  
 Aço Endurecido

## 252

### INNESTO FEMMINA

FEMALE PLUG  
 STECKER MIT INNENGEWINDE  
 EMBOUT FEMELLE  
 ADAPTADOR HEMBRA  
 PLUG COM ROSCA FÊMEA

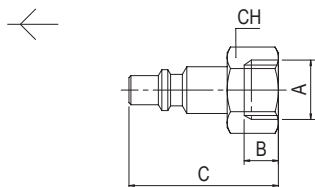

Code	A	B	C	CH	Pack.
00252 00 01 03 NB	1/4	11	38	17	10
00252 00 01 04 NB	3/8	11.5	38.5	19	10
00252 00 01 05 NB	1/2	14	41	24	10

## 252AC

### INNESTO IN ACCIAIO FEMMINA

STEEL FEMALE PLUG  
 STECKER MIT INNENGEWINDE AUS STAHL  
 EMBOUT FEMELLE EN ACIER  
 ADAPTADOR EN ACERO HEMBRA  
 PLUG EM AÇO COM ROSCA FÊMEA

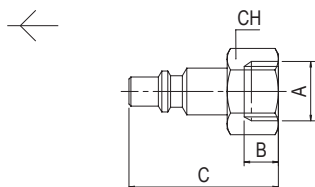

Code	A	B	C	CH	Pack.
252AC 00 51 03 ZI	1/4	11	38	17	10
252AC 00 51 04 ZI	3/8	11.5	38.5	19	10
252AC 00 51 05 ZI	1/2	14	41	24	10

**Acciaio Indurito**  
 Hardened Steel  
 Gehärtetem Stahl  
 Acier Trempé  
 Acero Curtido  
 Aço Endurecido

## 253

### INNESTO A CALZAMENTO CON MOLLA

COMPRESSION PLUG WITH SPRING  
 STECKER MIT KNICKSCHUTZFEDER  
 EMBOUT AVEC RESSORT DE PROTECTION  
 ADAPTADOR TUBO CON MUELLE  
 PLUG COM CONEXÃO PUSH-ON COM MOLA

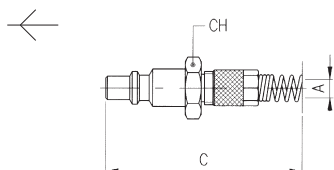

Code	A	C	CH	Pack.
00253 00 001	6/4	124.5	13	10
00253 00 002	8/6	130	13	10
00253 00 003	10/8	137.5	14	10
00253 00 004	12/10	143	16	10

**Molla Acciaio Inox AISI 304 - EN 1.4301**  
 Stainless Steel Spring AISI 304 - EN 1.4301  
 Edelstahlfeder AISI 304 - EN 1.4301  
 Ressort Acier Inoxydable AISI 304 - EN 1.4301  
 Muelle Acero Inoxidable AISI 304 - EN 1.4301  
 Mola Aço Inoxidável AISI 304 - EN 1.4301

## 254

### INNESTO A CALZAMENTO

COMPRESSION PLUG  
 STECKER MIT ÜBERWURFVERSCHRAUBUNG  
 EMBOUT À RACCORD À COIFFE  
 ADAPTADOR TUBO  
 PLUG COM CONEXÃO PUSH-ON

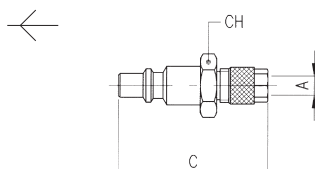

Code	A	C	CH	Pack.
00254 00 001	6/4	43.5	13	10
00254 00 002	8/6	43.5	13	10
00254 00 003	10/8	44.5	14	10
00254 00 004	12/10	46	16	10

## 255

### INNESTO CON PORTAGOMMA A RESCA

BARBED PLUG  
 STECKER MIT SCHLAUCHTÜLLE  
 EMBOUT À DOUILLE ANNELÉE POUR TUBE  
 ADAPTADOR ESPIGA  
 PLUG COM ESPIGÃO PARA TUBO DE BORRACHA



Code	A	C	D	Pack.
00255 00 01 X4 NB	6	44.5	12	10
00255 00 01 X7 NB	8	44.5	12	10
00255 00 01 X9 NB	10	47.5	14	10
00255 00 01 Y1 NB	12	47.5	16	10

## 255AC

### INNESTO IN ACCIAIO CON PORTAGOMMA A RESCA

STEEL BARBED PLUG  
 STECKER MIT SCHLAUCHTÜLLE AUS STAHL  
 EMBOUT À DOUILLE ANNELÉE POUR TUBE EN ACIER  
 ADAPTADOR EN ACERO ESPIGA  
 PLUG EM AÇOÙ COM ESPIGÃO PARA TUBO DE BORRACHA



Code	A	C	D	Pack.
255AC 00 51 X4 ZI	6	44.5	12	10
255AC 00 51 X7 ZI	8	44.5	12	10
255AC 00 51 X9 ZI	10	47.5	14	10
255AC 00 51 Y1 ZI	12	47.5	16	10

**Acciaio Indurito**  
 Hardened Steel  
 Gehärtetem Stahl  
 Acier Trempé  
 Acero Curtido  
 Aço Endurecido

## 256

### INNESTO CON PORTAGOMMA

PLUG FOR RUBBER HOSE  
 STECKER FÜR GUMMISCHLAUCH  
 EMBOUT POUR TUBE  
 ADAPTADOR CON PORTAGOMA  
 PLUG COM ESPIGÃO PARA TUBO DE BORRACHA

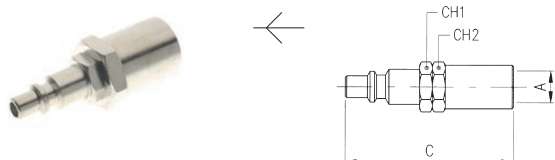

Code	A	C	CH1	CH2	Pack.
00256 00 001	14/6	60	15	17	10
00256 00 002	17/8	60	15	20	10
00256 00 003	19/10	60	15	22	10

## 257

### INNESTO A BAIONETTA

BAYONET PLUG  
 STECKER MIT BAJONETT-VERSCHLUSS  
 EMBOUT À RACCORD À BAJONNETTE  
 ADAPTADOR BAYONETA  
 PLUG COM CONEXÃO TIPO BAIONETA



Code	A	C	CH	Pack.
00257 00 001	15	38.5	15	10

## 258

### INNESTO A SCARICO PROGRESSIVO

PLUG WITH GRADUAL EXHAUST  
 STECKER MIT PROGRESSIVER ENTLASTUNG  
 EMBOUT À PASSAGE PROGRESSIF  
 ADAPTADOR DE DESCARGA PROGRESIVA  
 PLUG COM ESCAPE PROGRESSIVO

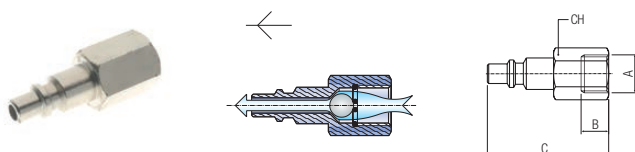

Code	A	B	C	CH	Pack.
00258 00 001	1/4	11	46.5	17	10