

SERIE 170 SWISS PROFILE



CARATTERISTICHE TECNICHE
 TECHNICAL CHARACTERISTICS
 TECHNISCHE ANGABEN
 CARACTÉRISTIQUES TECHNIQUES
 CARACTERÍSTICAS TÉCNICAS
 CARACTERÍSTICAS TÉCNICAS



Norma di Riferimento
 Reference standard
 Entspricht der Norm
 Norme de référence
 Normativa de referencia
 Norma de referência

1907/2006
REACH ✓

2011/65/CE
RoHS ✓

PED
 2014/68/UE

**SILICON
 FREE**

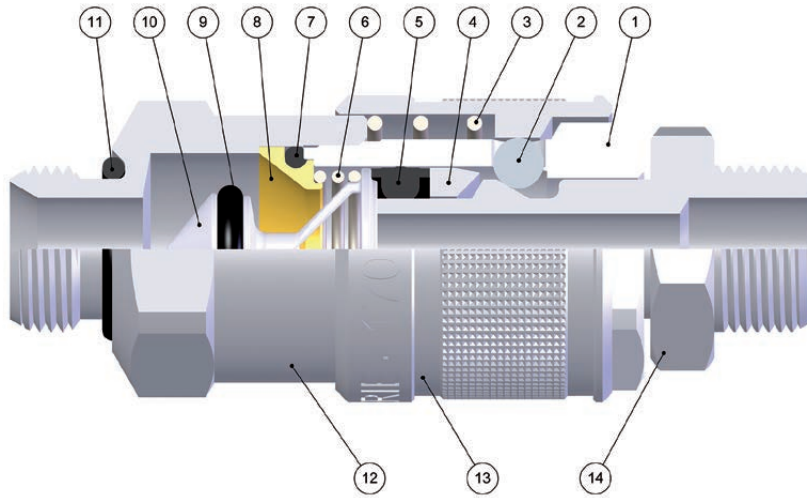

FKM A RICHIESTA
 IF REQUESTED FKM
 FKM AUF ANFRAGE
 FKM SUR DEMANDE
 FKM BAJO DEMANDA
 FKM SOB ENCOMENDA

DN
 5.5 mm

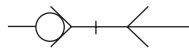

SWISS

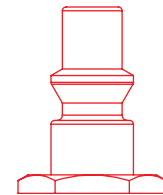

1:1

Materiali e Componenti

IT

- 1 Corpo in Ottone Nichelato
- 2 Sfera in Acciaio AISI 420
- 3 Molla Ghiera in Acciaio AISI 302
- 4 Anello Guida innesto in Ottone Nichelato
- 5 Guarnizione Corpo Sagomata in NBR
- 6 Molla Otturatore in Acciaio Aisi 302
- 7 Guarnizione O-Ring in NBR
- 8 Anello in ottone
- 9 Guarnizione O-Ring in NBR
- 10 Otturatore in Zama
- 11 Guarnizione O-Ring Filetto in NBR
- 12 Attacco Terminale In Ottone Nichelato
- 13 Ghiera in Ottone Nichelato
- 14 Innesto in Ottone Nichelato

Component Parts and Materials

GB

- 1 Nickel-Plated Brass Body
- 2 Stainless Steel AISI 420 Balls
- 3 Stainless Steel AISI 302 Ring Nut Spring
- 4 Nickel-Plated Brass Guide Ring Coupling
- 5 NBR Body Molded Seals
- 6 Stainless Steel AISI 302 Shutter Spring
- 7 NBR O-Ring Seals
- 8 Brass Ring
- 9 NBR O-Ring Seals
- 10 Zamak Shutter
- 11 NBR Thread O-Ring Seals
- 12 Nickel-Plated Brass Coupling Back Part
- 13 Nickel-Plated Brass Sleeve
- 14 Nickel-Plated Brass Plug Outline

Komponenten und Materialien

DE

- 1 Körper Messing Vernickelt
- 2 Kugel Edelstahl AISI 420
- 3 Entriegelungsfeder Edelstahl AISI 302
- 4 Stecker Führungsring Messing Vernickelt
- 5 Dichtung NBR
- 6 Verschlussfeder Edelstahl AISI 302
- 7 O-Ring NBR
- 8 Ring Aus Messing
- 9 O-Ring NBR
- 10 Verschluss Aus Zamak
- 11 O-Ring NBR
- 12 Einschraubkörper Messing Vernickelt
- 13 Entriegelungshülse Messing Vernickelt
- 14 Stecker Messing Vernickelt

Matériaux et Composants

FR

- 1 Corps: Laiton Nickelé
- 2 Bille: Acier Inoxydable AISI 420
- 3 Ressort de Bague: Acier Inoxydable AISI 302
- 4 Bague de Guidage: Laiton Nickelé
- 5 Joint en NBR
- 6 Ressort de Clapet: Acier Inoxydable AISI 302
- 7 Joint Torique en NBR
- 8 Bague en Laiton
- 9 Joint Torique en NBR
- 10 Clapet En Zamak
- 11 Joint Torique en NBR
- 12 Corps: Laiton Nickelé
- 13 Bague: Laiton Nickelé
- 14 Embout: Laiton Nickelé

Materiales y Componentes

ES

- 1 Cuerpo en latón niquelado
- 2 Esfera en acero AISI 420
- 3 Muelle tuerca en acero AISI 302
- 4 Anillo guía enchufe en latón niquelado
- 5 Junta en NBR
- 6 Muelle obturador en acero AISI 302
- 7 Junta tórica en NBR
- 8 Anillo en latón
- 9 Junta tórica en NBR
- 10 Obturador en Zamak
- 11 Junta tórica en NBR
- 12 Conexión terminal en latón niquelado
- 13 Tuerca en latón niquelado
- 14 Enchufe en latón niquelado

Materiais e Componentes

PT

- 1 Corpo em Latão Niquelado
- 2 Esfera em aço AISI 420
- 3 Mola da porca em aço AISI 302
- 4 Anel guia do plug em latão niquelado
- 5 Vedação em NBR
- 6 Mola do obturador em aço AISI 302
- 7 Vedação O-Ring em NBR
- 8 Anel em latão
- 9 Vedação O-Ring em NBR
- 10 Obturador em Zamak
- 11 Vedação O-Ring em NBR
- 12 Conexão terminal em latão niquelado
- 13 Porca em latão niquelado
- 14 Plug em latão niquelado



Pressione d'esercizio

Working Pressures

Betriebsdruck

Pression de service

Presión de Ejercicio

Pressão de Trabalho

-0.99 bar

16 bar



Max pressione statica (no pulsazioni)

Maximum static pressure (no pulsations)

Maximaler statischer Betriebsdruck (ohne pulsations)

Pression statique maximale (sans pulsation)

Presión estática máxima (sin pulsaciones)

Pressão estática máxima (sem pulsações)

35 bar



Temperature

Temperatures

Temperatur

Températures

Temperaturas

Temperaturas

- 20 °C

+ 80 °C

Con O-ring in FKM

With FKM O-ring

Mit O-ring in FKM

Avec joints en FKM

Con junta tórica en FKM

Com O-ring em FKM

- 10 °C

+ 200 °C



Fluidi compatibili

Aria compressa

Fluids

Compressed air

Geeignete Medien

Druckluft

Fluides compatibles

Air comprimé

Fluidos compatibles

Aire comprimido

Fluidos compatíveis

Ar comprimido

Per altri fluidi, consultare l'ufficio tecnico Aignep.

For other fluids, consult the technical department Aignep.

Für andere Flüssigkeiten, kontaktieren Sie uns.

Pour d'autres fluides, veuillez nous consulter.

Para otros fluidos póngase en contacto con el departamento técnico Aignep.

Para outros fluidos consulte o departamento técnico da Aignep.



Portata

NI/min

Flow Rate

Durchflusswerte

Débit

Caudal de Flujo

Vazão

| 6 bar Δ 1 | 6 bar Δ 0.5 | 6 bar * |
|--------------|----------------|------------|
| 1300 | 1000 | 1650 |

* Scarico libero - Exhaust Free - Freier Auslass - Échappement libre - Escape Libre - Descarga livre.



Filettatura

IT

Gas cilindrica conforme ISO 228 Classe A.

Threads

GB

Parallel gas in conformity with ISO 228 Class A.

Gewindearten

DE

Zylindrisches Gewinde nach Norm ISO 228 Classe A.

Filetages

FR

Filetage cylindrique conforme: ISO 228 Classe A.

Roscas

ES

Gas cilíndrica conforme ISO 228 Clase A.

Roscas

PT

Gas paralela conforme ISO 228 Classe A.

171

PRESA MASCHIO

MALE SOCKET
 VERSCHLUSS-KUPPLUNG MIT AUSSENGEWINDE
 COUPLEUR MÂLE
 ENCHUFE MACHO
 SOQUETE COM ROSCA MACHO

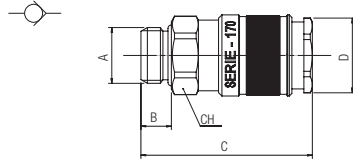

| Code | A | B | C | D | CH | Pack. |
|--------------|-----|----|----|----|----|-------|
| 00171 00 001 | 1/4 | 8 | 50 | 24 | 21 | 10 |
| 00171 00 002 | 3/8 | 9 | 51 | 24 | 21 | 10 |
| 00171 00 003 | 1/2 | 10 | 52 | 24 | 24 | 10 |

172

PRESA FEMMINA

FEMALE SOCKET
 VERSCHLUSS-KUPPLUNG MIT INNENGEWINDE
 COUPLEUR FEMELLE
 ENCHUFE HEMBRA
 SOQUETE COM ROSCA FÊMEA

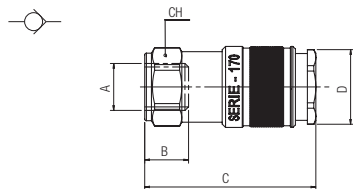

| Code | A | B | C | D | CH | Pack. |
|--------------|-----|----|------|----|----|-------|
| 00172 00 001 | 1/4 | 12 | 51 | 24 | 21 | 10 |
| 00172 00 002 | 3/8 | 12 | 52 | 24 | 21 | 10 |
| 00172 00 003 | 1/2 | 15 | 56,5 | 24 | 24 | 10 |

271

INNESTO MASCHIO

MALE PLUG
 STECKER MIT AUSSENGEWINDE
 EMBOUT MÂLE
 ADAPTADOR MACHO
 PLUG COM ROSCA MACHO

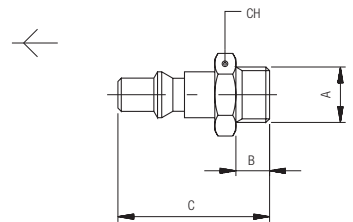

| Code | A | B | C | CH | Pack. |
|-------------------|-----|----|------|----|-------|
| 00271 00 01 03 NB | 1/4 | 8 | 36 | 17 | 10 |
| 00271 00 01 04 NB | 3/8 | 9 | 37 | 19 | 10 |
| 00271 00 01 05 NB | 1/2 | 10 | 38.5 | 24 | 10 |

271AC

INNESTO IN ACCIAIO MASCHIO

STEEL MALE PLUG
 STECKER MIT AUSSENGEWINDE AUS STAHL
 EMBOUT MÂLE EN ACIER
 ADAPTADOR EN ACERO MACHO
 PLUG EM AÇO COM ROSCA MACHO

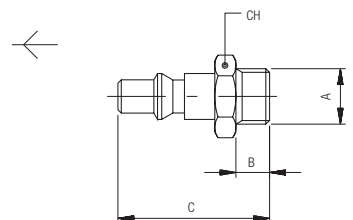

| Code | A | B | C | CH | Pack. |
|-------------------|-----|----|------|----|-------|
| 271AC 00 51 03 ZI | 1/4 | 8 | 36 | 17 | 10 |
| 271AC 00 51 04 ZI | 3/8 | 9 | 37 | 19 | 10 |
| 271AC 00 51 05 ZI | 1/2 | 10 | 38.5 | 24 | 10 |

Acciaio Indurito
 Hardened Steel
 Gehärtetem Stahl
 Acier Trempé
 Acero Curtido
 Aço Endurecido

272

INNESTO FEMMINA

FEMALE PLUG
 STECKER MIT INNENGEWINDE
 EMBOUT FEMELLE
 ADAPTADOR HEMBRA
 PLUG COM ROSCA FÊMEA

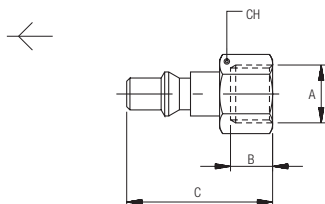

| Code | A | B | C | CH | Pack. |
|-------------------|-----|------|------|----|-------|
| 00272 00 01 03 NB | 1/4 | 11 | 36 | 17 | 10 |
| 00272 00 01 04 NB | 3/8 | 11.5 | 36.5 | 19 | 10 |
| 00272 00 01 05 NB | 1/2 | 14 | 39 | 24 | 10 |

272AC

INNESTO IN ACCIAIO FEMMINA

STEEL FEMALE PLUG
 STECKER MIT INNENGEWINDE AUS STAHL
 EMBOUT FEMELLE EN ACIER
 ADAPTADOR EN ACERO HEMBRA
 PLUG EM AÇO COM ROSCA FÊMEA

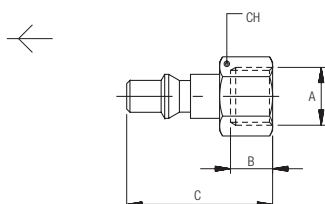

| Code | A | B | C | CH | Pack. |
|-------------------|-----|------|------|----|-------|
| 272AC 00 51 03 ZI | 1/4 | 11 | 36 | 17 | 10 |
| 272AC 00 51 04 ZI | 3/8 | 11.5 | 36.5 | 19 | 10 |
| 272AC 00 51 05 ZI | 1/2 | 14 | 39 | 24 | 10 |

Acciaio Indurito
 Hardened Steel
 Gehärtetem Stahl
 Acier Trempé
 Acero Curtido
 Aço Endurecido

273

INNESTO A CALZAMENTO CON MOLLA

COMPRESSION PLUG WITH SPRINGS
 STECKER MIT KNICKSCHUTZFEDER
 EMBOUT AVEC RESSORT DE PROTECTION
 ADAPTADOR TUBO CON MUELLE
 PLUG COM CONEXÃO PUSH-ON COM MOLA

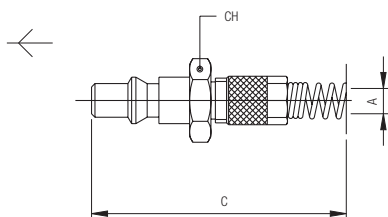

| Code | A | C | CH | Pack. |
|--------------|-------|-------|----|-------|
| 00273 00 001 | 6/4 | 122.5 | 13 | 10 |
| 00273 00 002 | 8/6 | 128 | 13 | 10 |
| 00273 00 003 | 10/8 | 135.5 | 14 | 10 |
| 00273 00 004 | 12/10 | 146 | 16 | 10 |

Molla Acciaio Inox AISI 304 - EN 1.4301
 Stainless Steel Spring AISI 304 - EN 1.4301
 Edelstahlfeder AISI 304 - EN 1.4301
 Ressort Acier Inoxydable AISI 304 - EN 1.4301
 Muelle Acero Inoxidable AISI 304 - EN 1.4301
 Mola Aço Inoxidável AISI 304 - EN 1.4301

274

INNESTO A CALZAMENTO

COMPRESSION PLUG
 STECKER MIT ÜBERWURFVERSCHRAUBUNG
 EMBOUT À RACCORD À COIFFE
 ADAPTADOR TUBO
 PLUG COM CONEXÃO PUSH-ON

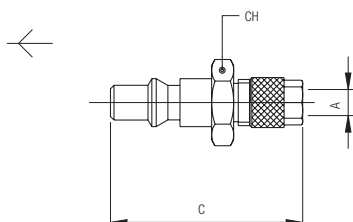

| Code | A | C | CH | Pack. |
|--------------|-------|------|----|-------|
| 00274 00 001 | 6/4 | 41.5 | 13 | 10 |
| 00274 00 002 | 8/6 | 41.5 | 13 | 10 |
| 00274 00 003 | 10/8 | 42.5 | 14 | 10 |
| 00274 00 004 | 12/10 | 44.5 | 16 | 10 |

275

INNESTO CON PORTAGOMMA A RESCA

BARBED PLUG
 STECKER MIT SCHLAUCHTÜLLE
 EMBOUT À DOUILLE ANNELÉE POUR TUBE
 ADAPTADOR ESPIGA
 PLUG COM ESPIGÃO PARA TUBO DE BORRACHA

| Code | A | C | D | Pack. |
|-------------------|----|------|----|-------|
| 00275 00 01 X4 NB | 6 | 42.5 | 11 | 10 |
| 00275 00 01 X7 NB | 8 | 42.5 | 11 | 10 |
| 00275 00 01 X9 NB | 10 | 45.5 | 14 | 10 |
| 00275 00 01 Y1 NB | 12 | 45.5 | 16 | 10 |

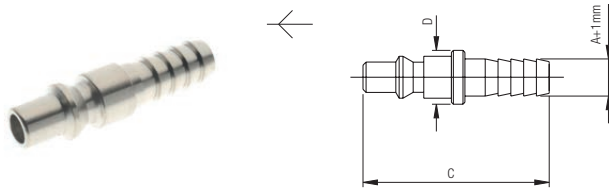

275AC

INNESTO IN ACCIAIO CON PORTAGOMMA A RESCA

STEEL BARBED PLUG
 STECKER MIT SCHLAUCHTÜLLE AUS STAHL
 EMBOUT À DOUILLE ANNELÉE POUR TUBE EN ACIER
 ADAPTADOR EN ACERO ESPIGA
 PLUG EM AÇO COM ESPIGÃO PARA TUBO DE BORRACHA

| Code | A | C | D | Pack. |
|-------------------|----|------|----|-------|
| 275AC 00 51 X4 ZI | 6 | 42.5 | 11 | 10 |
| 275AC 00 51 X7 ZI | 8 | 42.5 | 11 | 10 |
| 275AC 00 51 X9 ZI | 10 | 45.5 | 14 | 10 |
| 275AC 00 51 Y1 ZI | 12 | 45.5 | 16 | 10 |

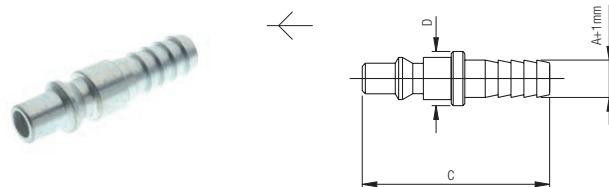

Acciaio Indurito
 Hardened Steel
 Gehärtetem Stahl
 Acier Trempé
 Acero Curtido
 Aço Endurecido

277

INNESTO A BAIONETTA

BAYONET PLUG
 STECKER MIT BAJONETT-VERSCHLUSS
 EMBOUT À RACCORD À BAIONNETTE
 ADAPTADOR BAYONETA
 PLUG COM CONEXÃO TIPO BAIONETA

| Code | A | C | CH | Pack. |
|--------------|----|------|----|-------|
| 00277 00 001 | 15 | 36.5 | 15 | 10 |

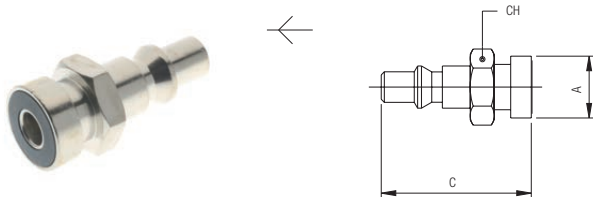

278

INNESTO A SCARICO PROGRESSIVO

PLUG WITH GRADUAL EXHAUST
 STECKER MIT PROGRESSIVER ENTLASTUNG
 EMBOUT À PASSAGE PROGRESSIF
 ADAPTADOR DE DESCARGA PROGRESIVA
 PLUG COM ESCAPE PROGRESSIVO

| Code | A | B | C | CH | Pack. |
|--------------|-----|----|------|----|-------|
| 00278 00 001 | 1/4 | 11 | 44.5 | 17 | 10 |

